

CODIGO **06484**

DESCRIPCION: **BOQUILLA DE ASPIRACION PISCINA PREFABRICADA**

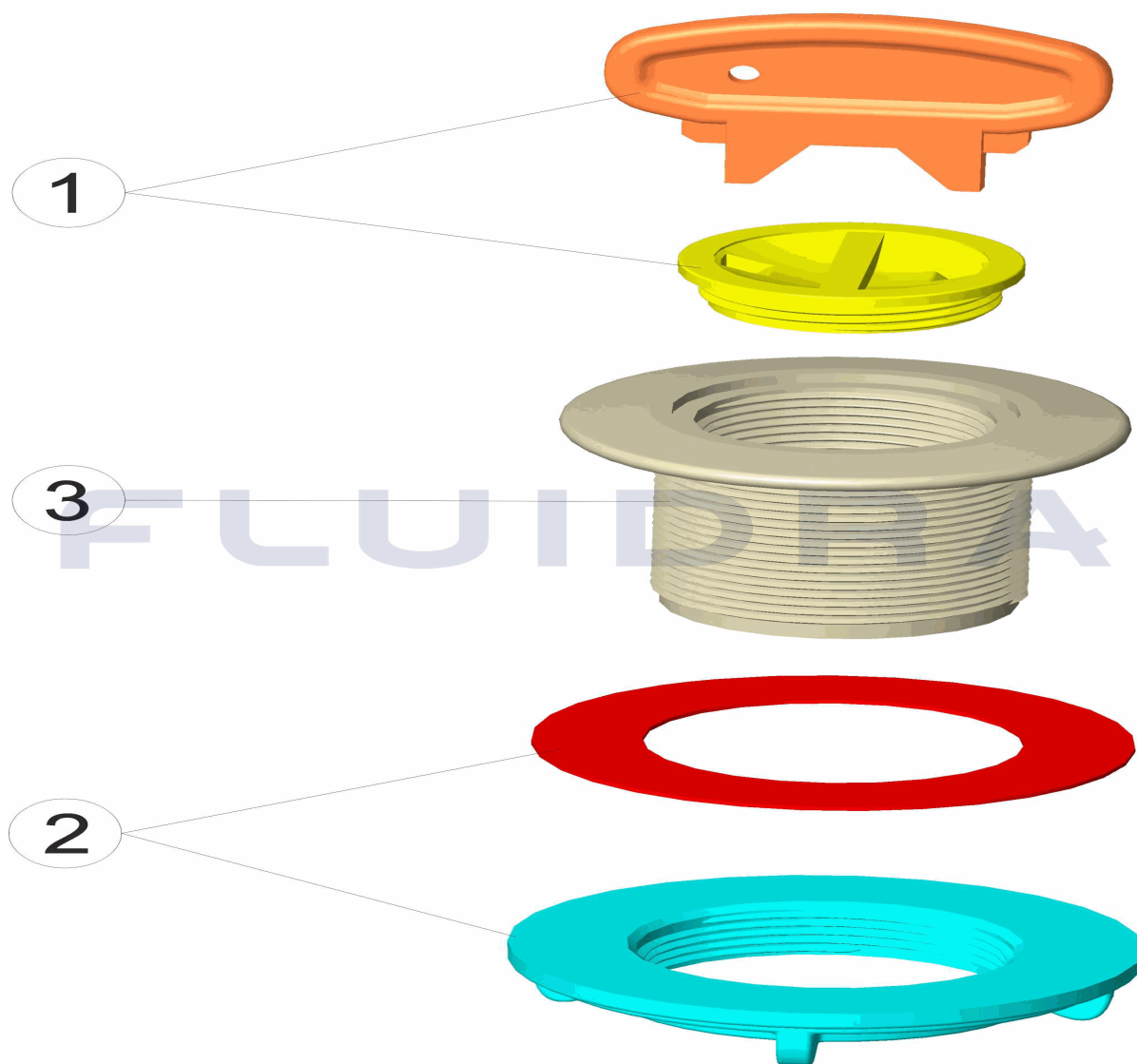

**ESPAÑOL**

POS	CODIGO	DESCRIPCION	CANTIDAD	POS	CODIGO	DESCRIPCION	CANTIDAD
1	4402043101	TAPON BOQUILLA		3	17239R0001	BASE BOQUILLA MULTIFLOW	
2	4402041701	TUERCA FIJACION CON JUNTA					

CODE **06484**

DESCRIPTION: **BOUCHE D'ASPIRATION PISCINE PRÉFABRIQUÉE**

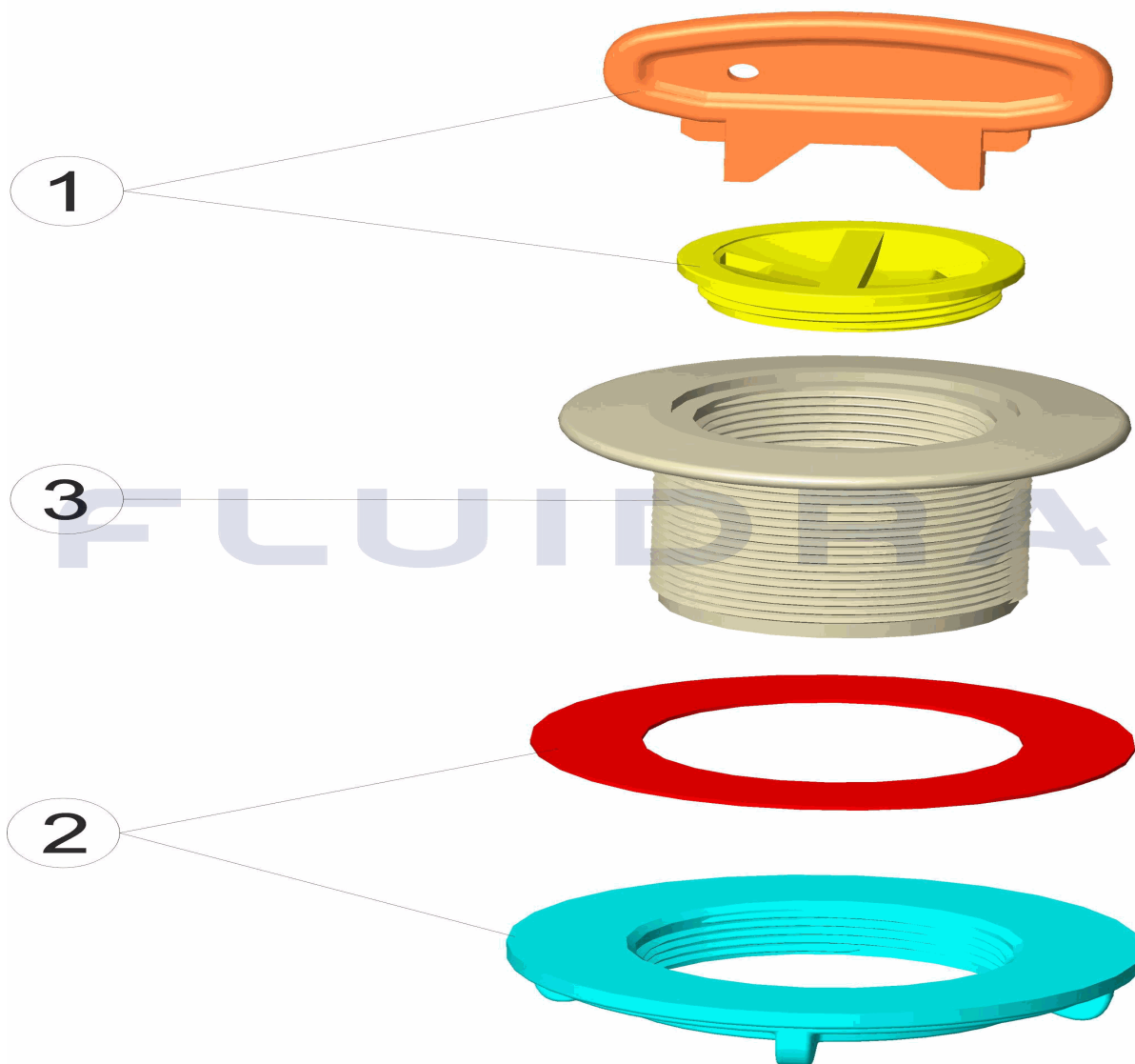

**FRANCAIS**

POS	CODE	DESCRIPTION	QUANTITE	POS	CODE	DESCRIPTION	QUANTITE
1	4402043101	BOUCHON DE BOUCHE		3	17239R0001	CORPS DE LA BUSE	
2	4402041701	ECROU DE FIXATION AVEC JOINT					

CODE **06484**

DESCRIPTION: **SUCTION NOZZLE PREFABRICATED POOL**

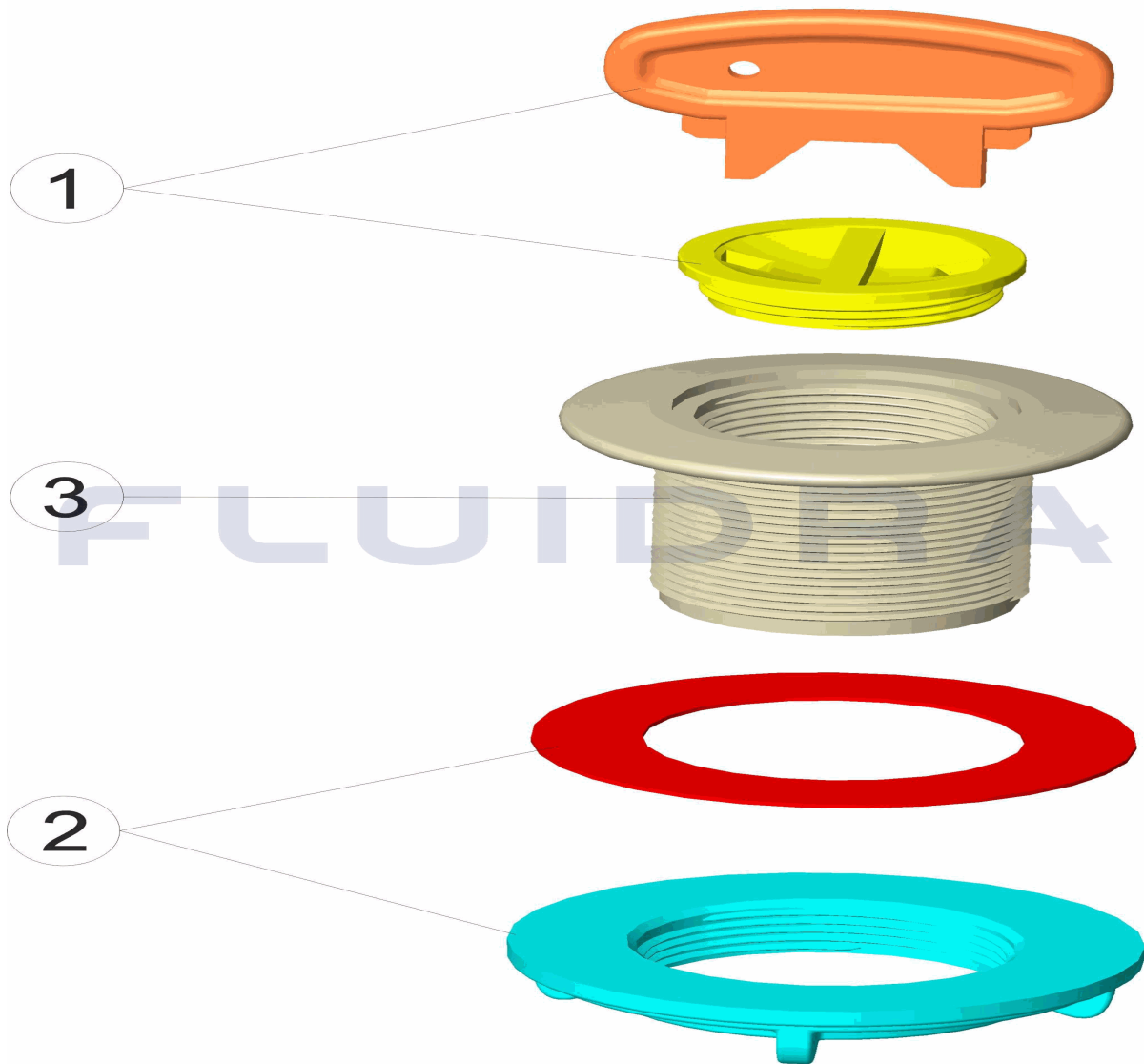

**ENGLISH**

POS	CODE	DESCRIPTION	QUANTITY	POS	CODE	DESCRIPTION	QUANTITY
1	4402043101	INLET CAP		3	17239R0001	INLET BASE	
2	4402041701	FIXING NUT AND GASKET					

CODICE **06484**

DESCRIZIONE: **BOCCHETTA D'ASPIRAZIONE PISCINA PREFABBRICATA**

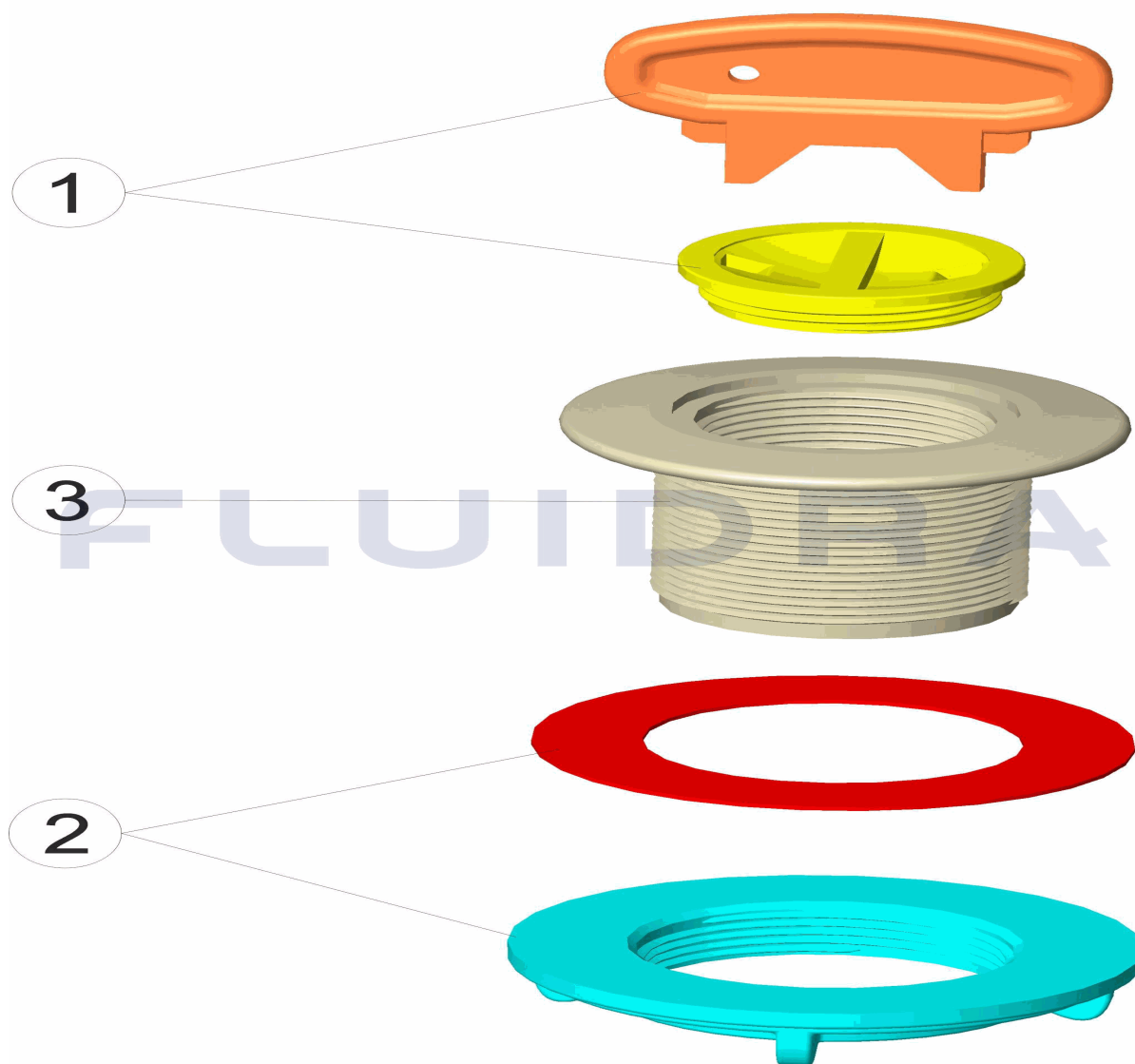

**ITALIANO**

POS	CODICE	DESCRIZIONE	QUANTITA'	POS	CODICE	DESCRIZIONE	QUANTITA'
1	4402043101	COPERCHIO BOCCHETTA		3	17239R0001	BASE BOCCHETTA	
2	4402041701	GHIERA FISSAGGIO CON GUARNIZIONE					

CODE **06484**

BESCHREIBUNG: ANSAUGDÜSE FERTIGBECKEN

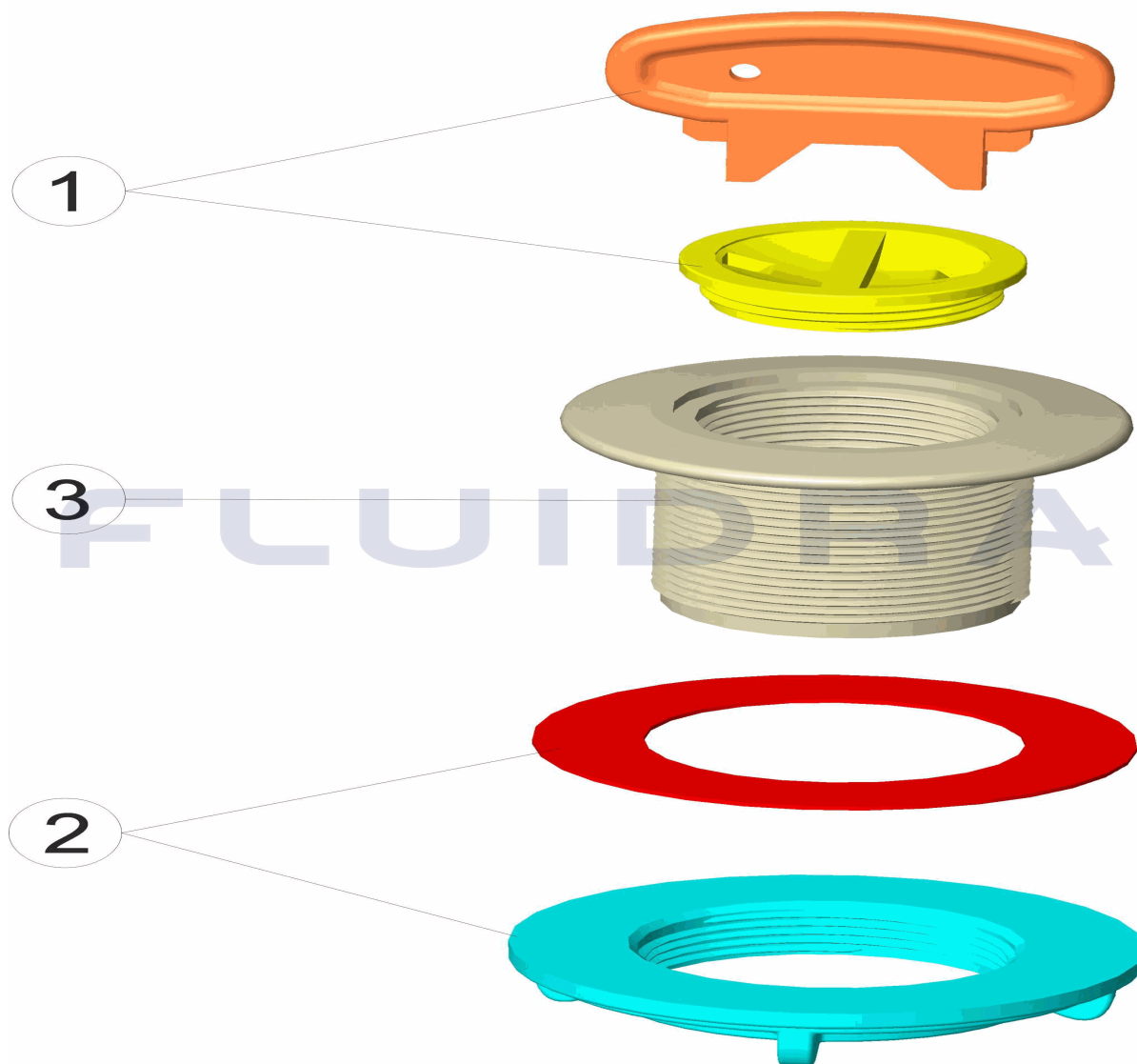

**DEUTSCH**

POS	CODE	BESCHREIBUNG	MENGE	POS	CODE	BESCHREIBUNG	MENGE
1	4402043101	STOPFEN DÜSE		3	17239R0001	DÜSENBASIS MULTIFLOW	
2	4402041701	FIXIERMUTTER UND DICHUNG					

CODIGO **06484**

DESCRIÇÃO: **BOQUILHA DE ASPIRAÇÃO PISCINA PRÉ-FABRICADA**

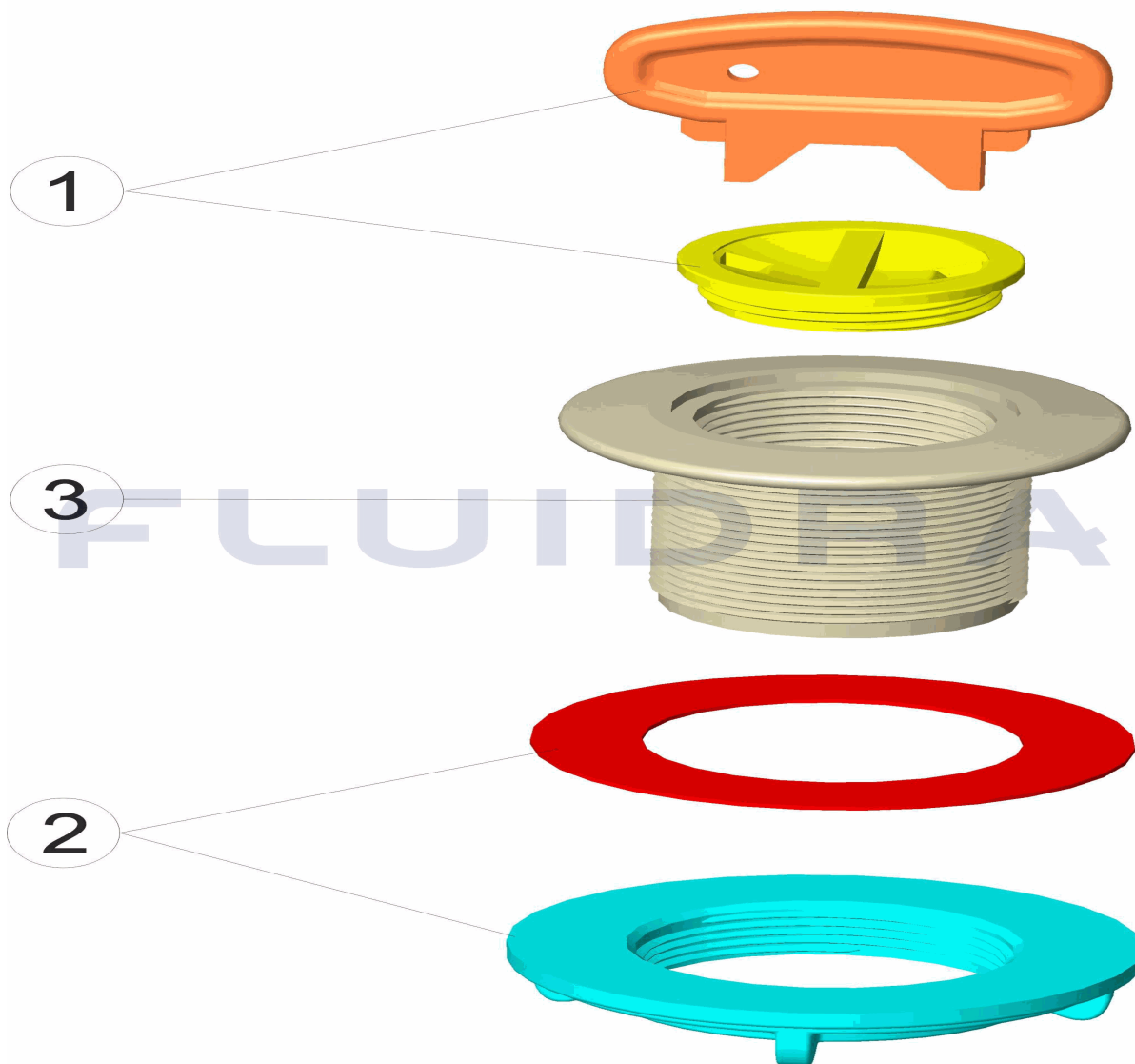

**PORTUGUES**

POS	CODIGO	DESCRIÇÃO	JANTIDADE	POS	CODIGO	DESCRIÇÃO	JANTIDADE
1	4402043101	TAMPÃO BOCA		3	17239R0001	BASE BOCA	
2	4402041701	PORCA FIXAÇÃO COM JUNTA					